

Bama Shower Seat

INSTALLATION INSTRUCTIONS

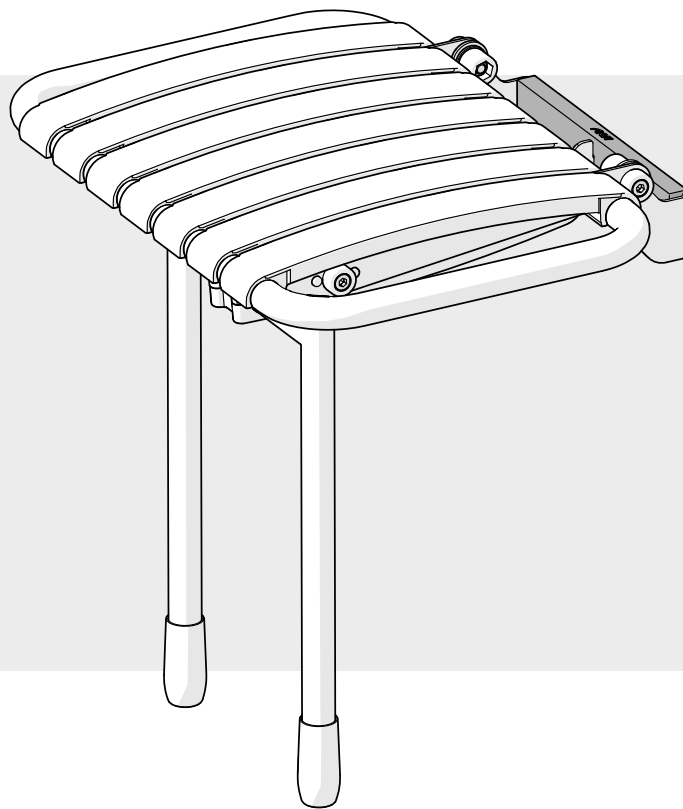

Important Information

Seat Dimensions

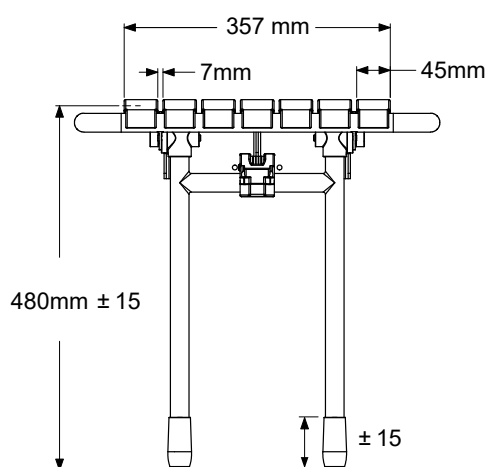
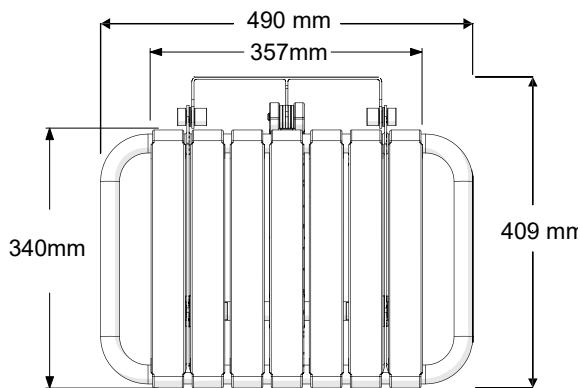

Mounting Bracket Dimensions

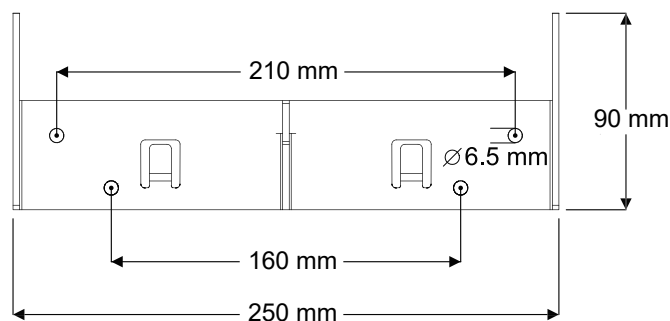

Do not use fixings with Countersunk heads. Fixings not supplied.



Never exceed the weight capacity of 31stone / 200kg / 440lb

Installation must be carried out in accordance with these instructions, and must be conducted by a qualified and competent installer.

Before you start

Remove all packaging and examine the product for any damage or manufacturing faults. Notify the retailer immediately if damage or faults are found. Check that all items are present before discarding any packaging. The manufacturer cannot be held responsible for any installation costs that may arise from damaged or faulty products being installed and not in accordance with these instructions.

The guarantee does NOT cover impact related damage, see warranty details. Please dispose all packaging in accordance with local recycling authorities.

Important Information

This seat must be attached to a vertical surface using suitable fixings appropriate to the type of surface and loading conditions to be applied. Ensure that both legs sit firmly on a flat surface, (maximum 1 in 40 shower base slope), when placed in the down position. Curved surfaces such as corners of bathtubs are not acceptable.

Safety

Ensure the wall type is suitable for this installation. **Max 200kg load rating** (depending on the wall type and suitable fixings). The maximum load rating for this seat is subject to the product being correctly fitted to a suitable wall/ mounting surface and the product being used on a suitable shower tray or floor surface. Acrylic shower trays are not suitable for use with this product. Always check for hidden pipe work or electrical wires before drilling.

- Do not stand on this seat.
- Always sit in the middle.
- Be aware of possible finger traps or pinch hazards.
- Children should be supervised at all times when using this seat.
- Keep children away from small parts and packaging.
- Please dispose all packaging in accordance with the local recycling authorities.

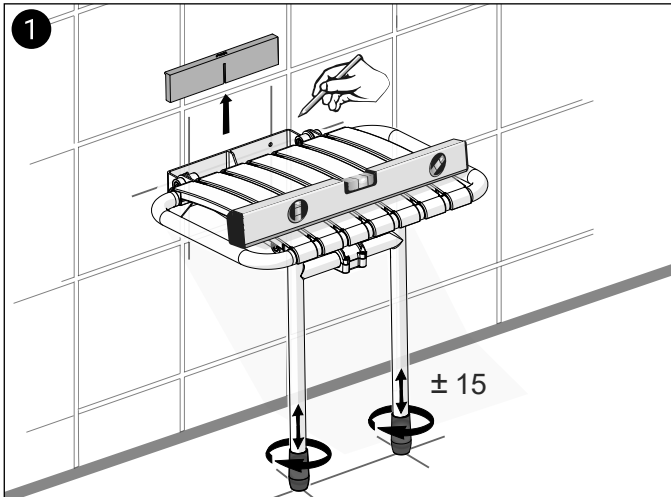

1 Determine the user height of the seat and measure this height against the wall. Adjust the feet to make finer adjustment. Remove the bracket cover.

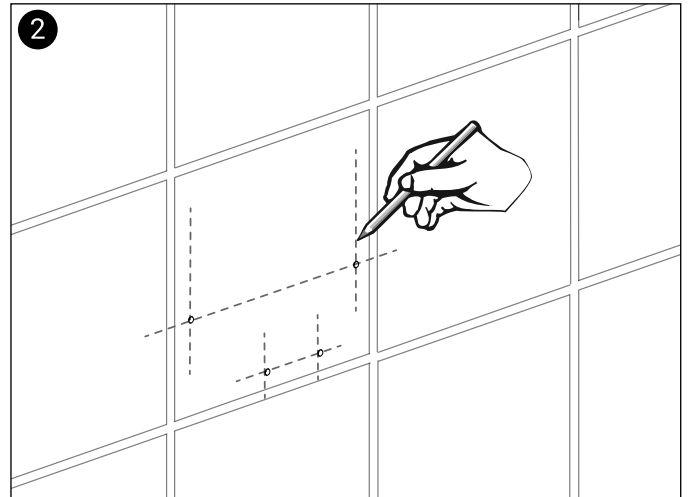

2 Mark the position of the mounting bracket holes on the wall ensuring the seat is level. Check for any obstacles or pipework before any drilling or fixing.

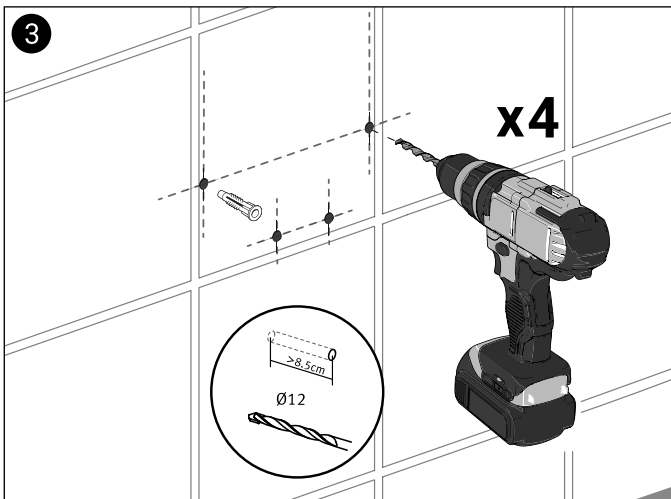

3 Use a piece of masking tape to mark the tiled wall and to protect the tile from splintering. Drill the holes with a suitable wall / tile drill piece. Fixings not supplied.

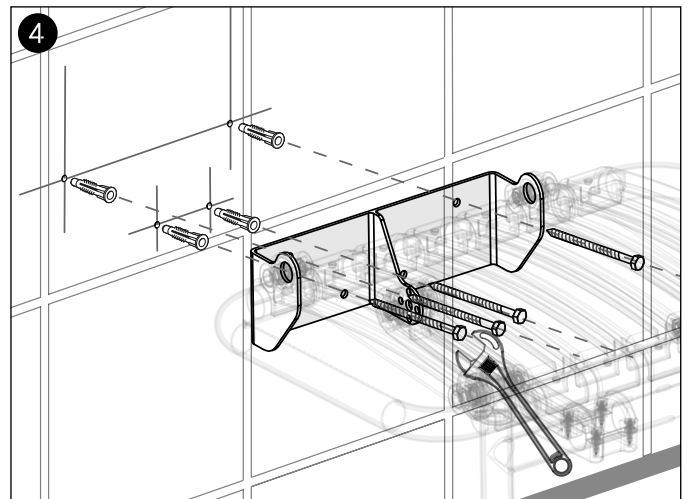

4 Use suitable wall fixings to secure the mounting bracket to the wall. Do not use countersunk screws as this can reduce the strength of the seat and will invalidate any warranty or weight capacity stated.

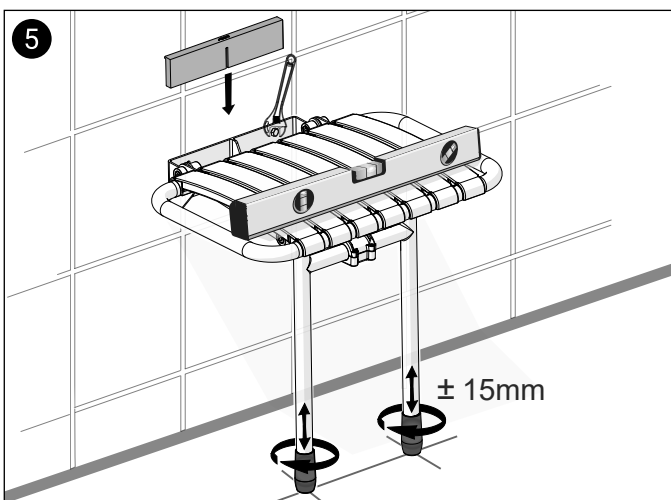

5 Do not over-tighten fixings. Check the seat operation, levels and leg positioning when it is raised and lowered. Replace the bracket cover.

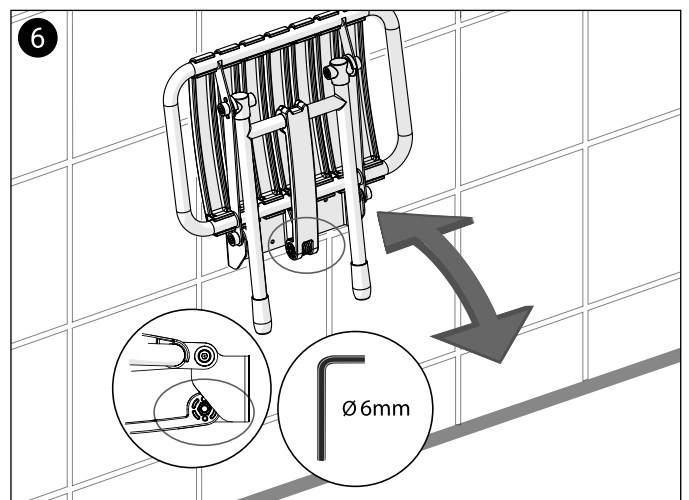

6 To adjust the rate the seat lowers, tighten or loosen the linkage bolt under the seat with a 6mm Allen key.

Contact

AKW[®]
Life Made Better

Orders & Quotes

01905 823 299
orders@akw-ltd.co.uk

General Enquiries

01905 823 298
sales@akw-ltd.co.uk

Technical Enquiries

01905 560 219
technicalenquiries@akw-ltd.co.uk

Kitchen Enquiries

01905 823 262
kitchens@akw-ltd.co.uk

Fax

01905 823 297

AKW

Pointon Way, Hampton Lovett
Droitwich Spa, WR9 0LR

www.akw-ltd.co.uk
orders.akw-ltd.co.uk

Follow us on Social:



Guarantee

The life time guarantee applies only to manufacturing or material defects, conditional on the one-time correct installation of the product.

Does not apply to:

- Inappropriate use or accidental damage.
- Damage or defects that result from incorrect installation.
- Lack of maintenance including the build up of grime or damage resulting from inappropriate cleaning.
- Damage or defects that result from repairs or modifications undertaken by unauthorised persons.
- This guarantee excludes general wear and tear through usage and does not apply to surface finishes.

What to do if something goes wrong?

In the event that you should encounter a problem with this product, please contact your local installer and if this does not resolve the issue, then contact AKW technical team who will provide further advice and, if necessary, arrange for a maintenance engineer to visit and report any issues. See the T&Cs on our website or our catalogue for further information. None of the foregoing affects your statutory rights.